



Main features

- Temperature Limits: - 200 ... + 600° C
- Tolerance: UNI 7937, IEC 751 standards:
 - ± 0.15° C at 0° C for class A (1/2 DIN)
 - ± 0.30° C at 0° C for class B (1 DIN)
 - ± 0.10° C at 0° C for class 1/3 DIN
- Compact mineral insulated (MgO) resistance thermometer element (Pt100 at 0°C) and continuous metal sheath
- Application versatility

MODELS

TR6M A
without fitting

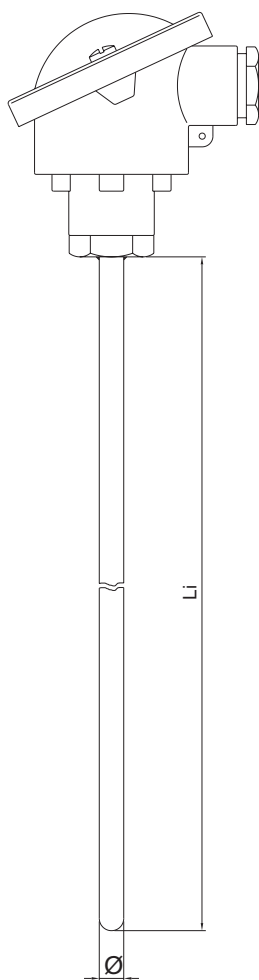

TR6M B
with adjustable
compression fitting

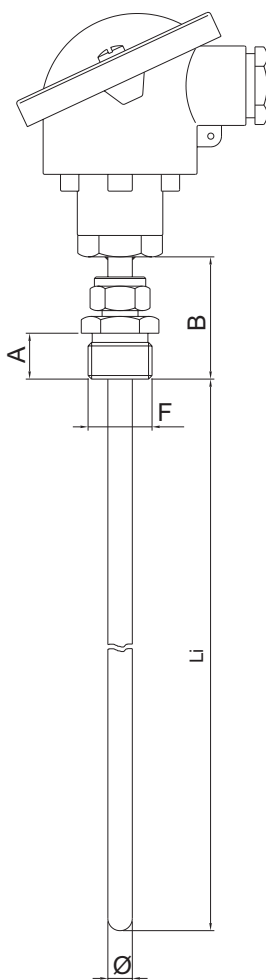

TR6M D
with welded fitting
under the head

